



DC2200iX DRYING CABINET

The PLC controlled DC2200 provides excellent means to speed up the processing of equipment in busy medical and laboratory application. It secures the appropriate conditions for drying of cleaned and disinfected items by using HEPA filtered air at controlled temperature for various articles and materials.

- By drying 2-3 times faster than a washer-disinfector with an integrated dryer, it saves both time and energy and enables the simultaneous washing & disinfection / drying routines. Thus, the flow of goods becomes quicker and the whole processing a lot more economical.
- Programmable Logic Control with a colour Touch-Screen user interface & info panel enables the use of fixed pre-set, nominated cycles by a press of a button and also allows adjustments to meet specific requirements.
- Safe, shockproof and thermally insulated double glazed door(s) enable the identification of the load in the chamber. In the pass-through model only one door can be opened in turn.
- Optional process data downloading to a FTP server and/or network printer provides the means for connection to tracking systems.
- Constructed and designed to provide the maximum flexibility and capacity. The dedicated retractable AN-hose cassettes and holder shelf can accommodate upto 64 long hoses. Max number of shelves is 13, wherof one comes as standard for AN-hoses.
- Heat exchanger for saving electricity and decreasing humidity exhaust.

Features:

- sound & heat insulated
- heat exchanger
- single door or pass-through, left/right hinged door(s)
- adjustment of the vertical distance between retractable shelves
- PLC and 4" graphic colour Touch-Screen control panel & info display
- 3 pre-set drying cycles, max 6
- temperature adjustment range 30-80 °C
- time adjustment range 20 -180 minutes
- cooling time range 1-30 minutes
- temperature & remaining time indication
- HEPA -filter condition indication
- double overheating protection

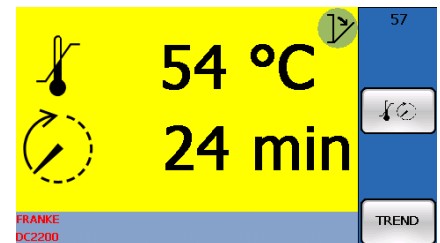
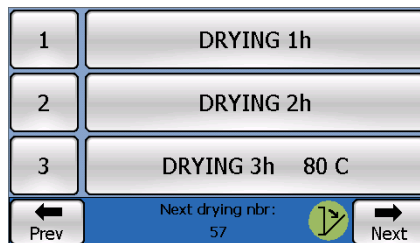

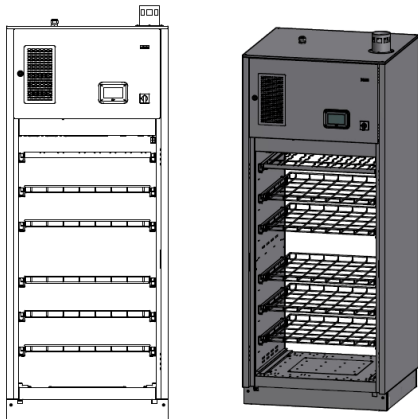

Model, code 374022

as 1-door or pass-through:

Included as standard:

- 5 wire shelves, L618xD605 mm
- 1 AN-hose holder shelf, for 35 pcs

Options:

- shelf incl. consoles (max +7)

Tray capacity:

DIN 1/1, 480x255x50mm: 10 / max 26*
 DIN 1/2, 240x255x50mm: 20 / max 52*

SPRI 1/1, 450x340x70mm: 5 / max 13*
 SPRI 1/2, 340x250x70mm: 20 / max 52*

*max no. is stated with 13 pcs of wire shelves

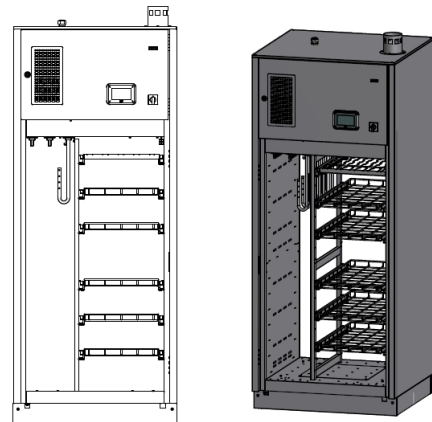

Model, code 374026

as 1-door or pass-through:

Included as standard:

- 5 wire shelves, L359xD678 mm
- 1 AN-hose holder shelf, for 25 pcs
- 2 hose cassettes, for 13 pcs/ea
- 1 respirator bag cassette, for 7 pcs

Options:

- shelf incl. consoles (max +7)
- hose cassette
- respirator bag cassette

Tray capacity:

DIN 1/1, 480x255x50 mm: 5 / max 13*
 DIN 1/2, 240x255x50 mm: 10 / max 26*

SPRI 1/1, 450x340x70mm: 5 / max 13*
 SPRI 1/2, 340x250x70mm: 10 / max 26*

*max no. is stated with 13 pcs of wire shelves

Single-door models

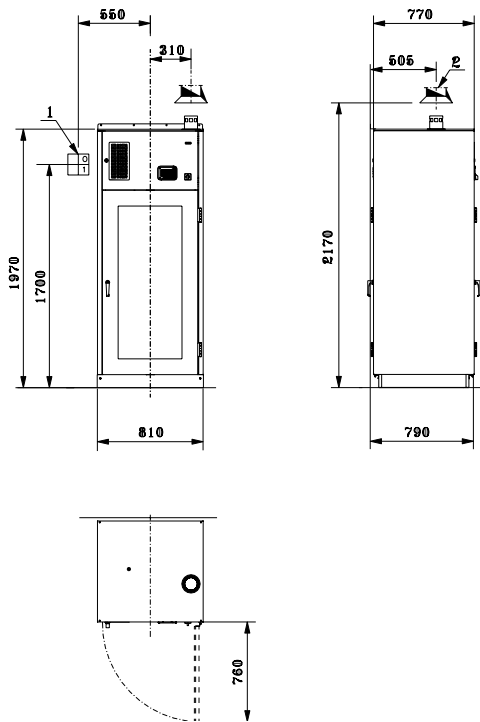

Pass-through models

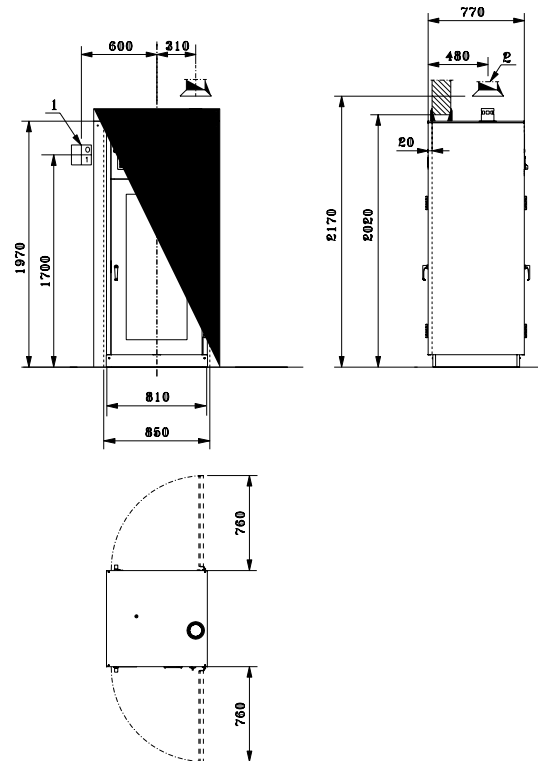

Technical Data

Material: polished CrNi stainless steel EN 1.4301
 Outer dimensions: W810xD770xH1970 mm
 Chamber size (gr): W686xD710xH1260 mm, 613 L
 Weight: 220 kg
 CB –certified . IEC 61010-1

Description

Mean sound power level (A)	68 dBA
Peak sound power level (A)	70 dBA
Drying fan	110 m ³ /h / 0.4 kW
Heating power 230 V - 3 phase	4760 W
Heating power 200 V - 3 phase	4760 W
Heating power single phase 230 V	3260 W

Plate values	Voltage	Current	Power	Frequency	Phases	Fuse
U 400 V 3N AC 50 Hz, 11.5 A	400 V	11,5	5700W/400V	50/60 Hz	3 N	3x16A
U 415 V 3N AC 50 Hz, 12 A	415 V	12	5700W/400V	50/60 Hz	3 N	3x16A
U 230 V 1N AC 50 Hz, 16 A	230 V	16	3600W/230V	50/60 Hz	1 N	1x16A
U 220 V 3PH AC 50 Hz, 18 A	220 V	18	5700W/220V	50/60 Hz	3 Ph	3x20A
U 208 V 3PH AC 50 Hz, 17 A	208 V	17	5700W/208V	50/60 Hz	3 Ph	3x20A

Franke Medical Oy
 Vartiokuja 1
 FIN-76850 Naarajärvi
 Finland

Telephone +358 15 34111
 www.franke.fi